

Genuine Branch MC4 Connector SE015HA, SE015HB

Branch Connector Socket



Branch Connector Plug

- For a safe and simple parallel or serial-parallel connection of PV-modules.
- Pluggable with single-pole Stäubli PV-cable coupler MC4. Unmated connections must be protected by sealing caps.

Technical Data		
Connector system	Ø 4 mm	
Rated voltage	1500 V DC (UL)	
Rated current	50 A	
Rated impulse voltage	12 kV	
Ambient temperature range	-40°C...+85°C (UL)	
Upper limiting temperature	105°C (Stäubli)	
Degree of protection	mated	IP67
	unmated	IP2X
Overvoltage category / Pollution degree	CATIII /2	
Contact resistance of plug connectors	≤0.5 mΩ	
Safety class	II	
Contact system	MULTILAM	
Contact material	Copper, tin plated	
Insulation material	PC	
Locking system (UL)	Locking type	
Flame class	UL94-V0	
UL recognized component, in accordance with UL 6703	E343181	

Dimensions (mm)

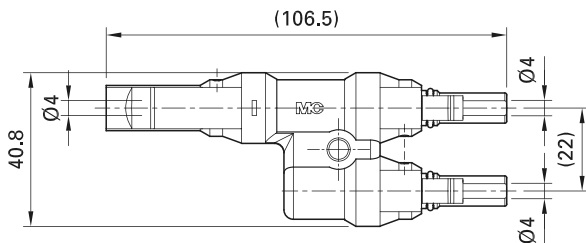

Branch Connector Socket

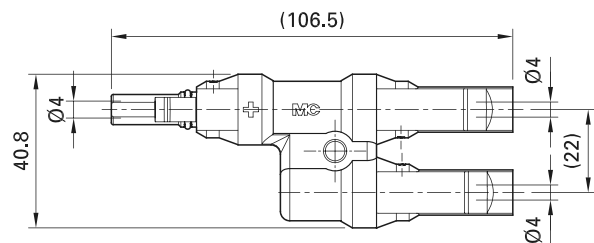

Branch Connector Plug

Installation Diagram

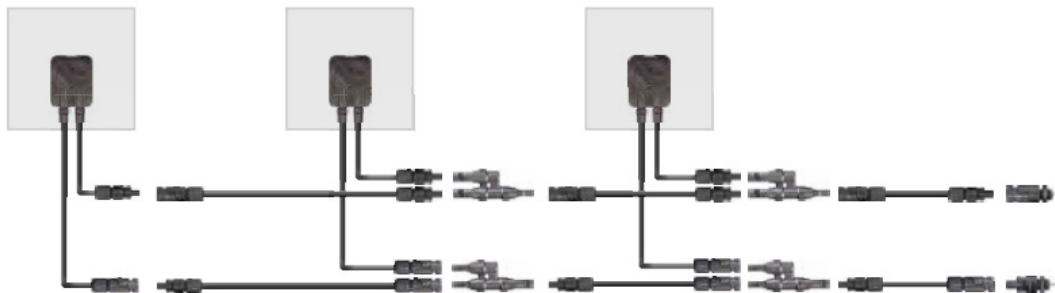

Please Note:

Please consult with your Electrician/Engineer to ensure suitability for the intended application and installation.

PGK Distribution takes every precaution to ensure the information in this publication is correct but accepts no liability of any kind and reserves the right to change any detail in this catalogue without notification.